

SITE CLASSIFICATION - CLASS 'A'  
(REFER TO SITE REPORT FOR  
DETAILS) WIND LOAD - N1  
CORROSION CLASSIFICATION - R3

**BRICK NOTE**

- 2c FACE BRICK TO BE LAID IN THIRD BOND U.N.O  
**STEEL ROOF IN ACCORDANCE TO  
NASH STANDARDS**

**ROOF NOTE**

- COLORBOND ROOF, PITCH AT 38° W/ 500W EAVES UNO  
- STEEL ROOF IN ACCORDANCE TO NASH STANDARD  
- CEILING AT 31c + PLATE UNLESS NOTED OTHERWISE

**ROOF PLUMBER NOTE**

- PROVIDE SLOTTED GUTTERS (EXC. GUTTER ON WALLS)  
- FINAL POSITIONS OF R/WP'S TO BE DETERMINED ON SITE  
- R/WP'S IN PORCH TO BE STRAIGHT CONNECTION TO STORMWATER  
SYSTEM (NO KICK)

**BRICKLAYER NOTE**

- FOR 2c GARAGE:  
- 28c GARAGE HAS 3c LINTEL

**LOFT NOTE**

- STAIR CONSTRUCTION  
STAIRWAY TREADS NON-SLIP TO TABLE 3.9.1.1 BCA VOL. 2  
- HANDRAIL CONSTRUCTION  
HANDRAILS TO COMPLY W/ CLAUSE 3.9.2.3 & 3.9.2.4 BCA VOL. 2  
- PROTECTION OF OPENABLE WINDOWS  
BEDROOM WINDOWS TO COMPLY W/ CLAUSE 3.9.2.5 BCA VOL. 2

**LANDSCAPING NOTE**

- REFER TO LANDSCAPING PAGE FOR EXTENT/TYPE OF FLOOR COVERINGS  
TO ALFRESCO & OUTDOOR AREAS

**DO NOT SCALE FROM THIS DRAWING**  
All Sub-contractors to check dimensions  
& notes prior to initiating works. Any  
discrepancies to be notified to the Site  
Supervisor without delay.  
**ALL DIMENSIONS TO BRICKWORK.**

**ELECTRICAL NOTE**

- INTERCONNECTED SMOKE DETECTORS TO  
PART 3.7.2.2 BCA VOL. 2 AS INDICATED ON PLAN

**FIXING CARPENTER NOTE**

- 4 No. 450D SHELVES TO PANTRY AND LINEN UNO  
- 450D SHELF & RAIL TO ALL WIR, ROBE & ROBE REC. UNO  
- 450D SHELF AT 1750 AFL TO BROOM CUPBOARD, IF ANY

**GARAGE NOTE**

- SINGLE LEAF WALL TO GARAGE IS NOT WATERPROOF  
- FALL GARAGE SLAB 20mm TOWARDS MAIN GARAGE OPNG

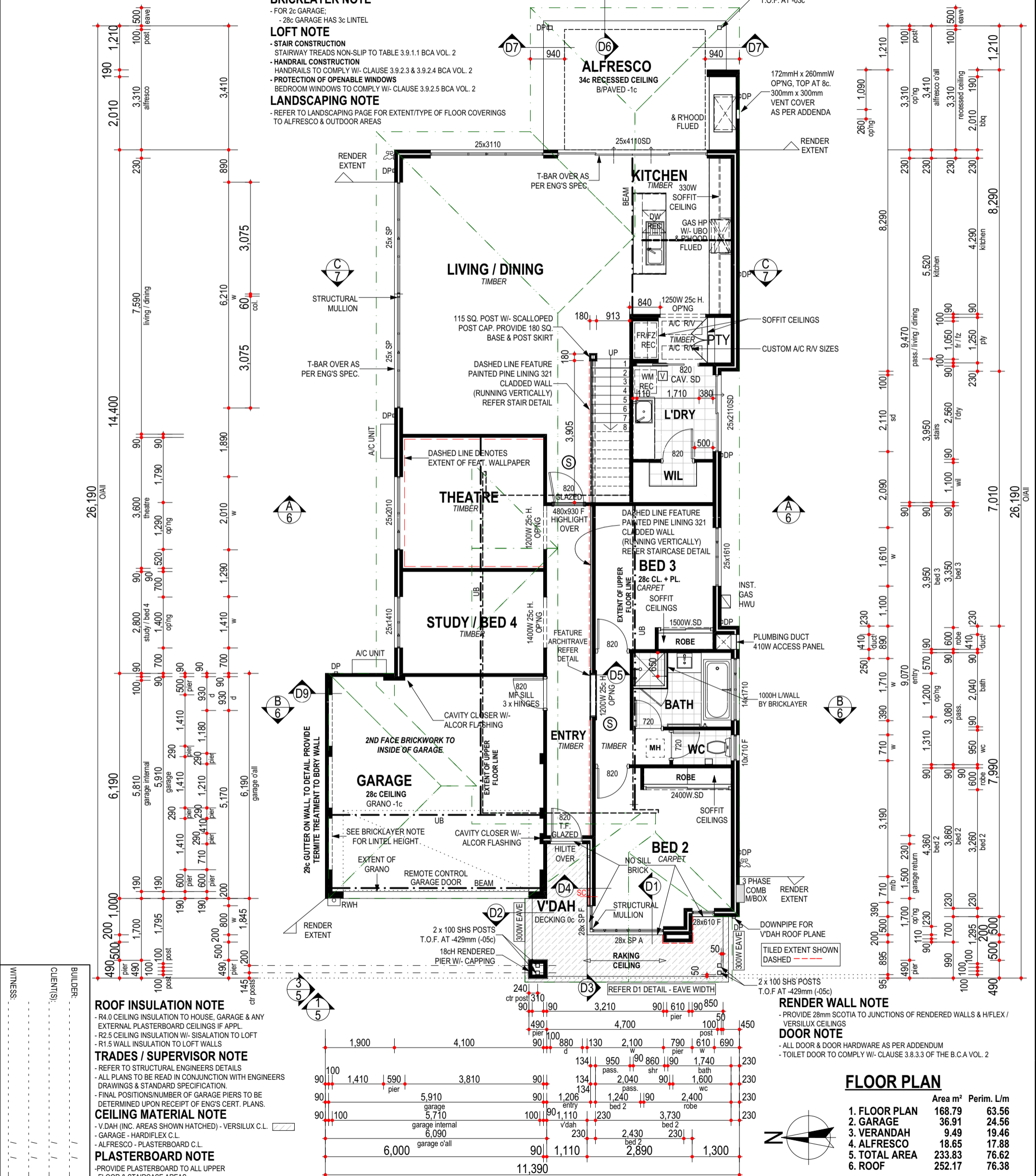

**ROOF INSULATION NOTE**

- R4.0 CEILING INSULATION TO HOUSE, GARAGE & ANY  
EXTERNAL PLASTERBOARD CEILING IF APPL.  
- R2.5 CEILING INSULATION W/ SALSATION TO LOFT  
- R1.5 WALL INSULATION TO LOFT WALLS

**TRADES / SUPERVISOR NOTE**

- REFER TO STRUCTURAL ENGINEERS DETAILS  
- ALL PLANS TO BE READ IN CONJUNCTION WITH ENGINEERS  
DRAWINGS & STANDARD SPECIFICATION.  
- FINAL POSITIONS/NUMBER OF GARAGE PIERS TO BE  
DETERMINED UPON RECEIPT OF ENG'S CERT. PLANS.

**CEILING MATERIAL NOTE**

- V.DAH (INC. AREAS SHOWN HATCHED) - VERSILUX C.L.  
- GARAGE - HARDIFLEX C.L.  
- ALFRESCO - PLASTERBOARD C.L.

**PLASTERBOARD NOTE**

- PROVIDE PLASTERBOARD TO ALL UPPER  
FLOOR & STAIRCASE AREAS

**RENDER WALL NOTE**

- PROVIDE 28mm SCOTIA TO JUNCTIONS OF RENDERED WALLS & H/FLEX/  
VERSILUX CEILING

**DOOR NOTE**

- ALL DOOR & DOOR HARDWARE AS PER ADDENDUM  
- TOILET DOOR TO COMPLY W/ CLAUSE 3.8.3.3 OF THE B.C.A VOL. 2

**FLOOR PLAN**

|               | Area m <sup>2</sup> | Perim. L/m |
|---------------|---------------------|------------|
| 1. FLOOR PLAN | 168.79              | 63.56      |
| 2. GARAGE     | 36.91               | 24.56      |
| 3. VERANDAH   | 9.49                | 19.46      |
| 4. ALFRESCO   | 18.65               | 17.88      |
| 5. TOTAL AREA | 233.83              | 76.62      |
| 6. ROOF       | 252.17              | 76.38      |

TANGENT NOMINEES PTY LTD (A.C.N. 008 865 585)  
TRUSTEE FOR THE SUMMIT HOMES GROUP UNIT TRUST.

PROPOSED RESIDENCE FOR:  
**TANGENT HOMES NOMINEES**

ADDRESS  
**LOT 375 PALLIUM WAY,  
JINDALEE**

**VARIATIONS:**  
PRESTART - 26.08.16 - DOS  
CERTIFIEDS - 6.09.16 - DOS  
LSCAPE CERTS - 21.09.16 - DOS  
ERROR LOG - 11.10.16 - DOS  
V001 - 4.11.16 - ELEC - DOS  
V002 - 8.12.16 - AIR CON - DOS

V003 - 10.03.17 - LOFT INSULATION - THO  
V004 - 03.04.17 - ALFRESCO - THO  
V005 - 05.04.17 - KITCHEN SINK - THO  
V007 - 07.04.17 - BED 2 WINDOW - THO  
V008 - 13.04.17 - MASTER SUITE - THO  
V009 - 28.04.17 - CLADDING - AEN  
V010 - 01.06.17 - BBQ & R'HOOD - THO

LAST OPENED:

Thu 01 Jun 2017

TIME:

08:19:36

DATE: 18.06.16

DRN: DONNA

CHD:

SCALE: 1:100

© COPYRIGHT 2017

SHEET 1 OF 22

NG EDEN BEACH DISPLAY

JOB NO: 149444

242 LEACH HIGHWAY MYAREE, W.A. 6154.  
TELEPHONE (08) 9317 0100 FAX (08) 9330 4507

SITE CLASSIFICATION - CLASS 'A'  
(REFER TO SITE REPORT FOR  
DETAILS) WIND LOAD - N1  
CORROSION CLASSIFICATION - R3

STEEL ROOF IN ACCORDANCE TO  
NASH STANDARDS

**ROOF NOTE**

- COLORBOND ROOF, PITCH AT 38° (UNO) W/ 500W EAVES UNO  
- STEEL ROOF IN ACCORDANCE TO NASH STANDARD  
- CEILINGS AT 31c + PLATE UNLESS NOTED OTHERWISE

**ROOF INSULATION NOTE**

- R4.0 CEILING INSULATION TO HOUSE, GARAGE & ANY EXTERNAL  
- PLASTERBOARD CEILINGS IF APPLICABLE  
- R2.5 CEILING INSULATION W/ SISALATION TO LOFT  
- R1.5 WALL INSULATION TO ALL LOFT WALLS

**WALL INSULATION NOTE**

- PROVIDE R1.5 INSULATION TO ALL FRAMED WALLS

**FIXING CARPENTER NOTE**

- 4 No. 450D SHELVES TO PANTRY AND LINEN UNO  
- 450D SHELF & RAIL TO ALL WIR, ROBE & ROBE REC. UNO  
- 450D SHELF AT 1750 AFL TO BROOM CUPBOARD, IF ANY

**ELECTRICAL NOTE**

- INTERCONNECTED SMOKE DETECTORS TO PART 3.7.2.2 BCA VOL. 2 AS  
INDICATED ON PLAN

**FIXING CARPENTER NOTE**

- 4 No. 450D SHELVES TO PANTRY AND LINEN UNO  
- 450D SHELF & RAIL TO ALL WIR, ROBE & ROBE REC. UNO  
- 450D SHELF AT 1750 AFL TO BROOM CUPBOARD, IF ANY

**TRADES / SUPERVISOR NOTE**

- REFER TO STRUCTURAL ENGINEERS DETAILS  
- ALL PLANS TO BE READ IN CONJUNCTION WITH ENGINEERS DRAWINGS &  
STANDARD SPECIFICATION.  
- FINAL POSITIONS/NUMBER OF GARAGE PIERS TO BE DETERMINED UPON  
RECEIPT OF ENG'S CERT. PLANS.

**DOOR NOTE**

- ALL DOOR & DOOR HARDWARE AS PER ADDENDUM  
- TOILET DOOR TO COMPLY W/ CLAUSE 3.8.3.3 OF THE B.C.A VOL. 2

**PLASTERBOARD NOTE**

- PROVIDE PLASTERBOARD TO ALL UPPER  
FLOOR & STAIRCASE AREAS

**USM NOTE**

- **STAIR CONSTRUCTION**  
STAIRWAY TREADS NON-SLIP TO TABLE 3.9.1.1 BCA VOL. 2  
- **HANDRAIL CONSTRUCTION**  
HANDRAILS TO COMPLY W/ CLAUSE 3.9.2.3 & 3.9.2.4 BCA VOL. 2  
- **PROTECTION OF OPENABLE WINDOWS**  
BEDROOM WINDOWS TO COMPLY W/ CLAUSE 3.9.2.5 BCA VOL. 2

**DO NOT SCALE FROM THIS DRAWING**  
All Sub-contractors to check dimensions  
& notes prior to initiating works. Any  
discrepancies to be notified to the Site  
Supervisor without delay.  
ALL DIMENSIONS TO BRICKWORK.

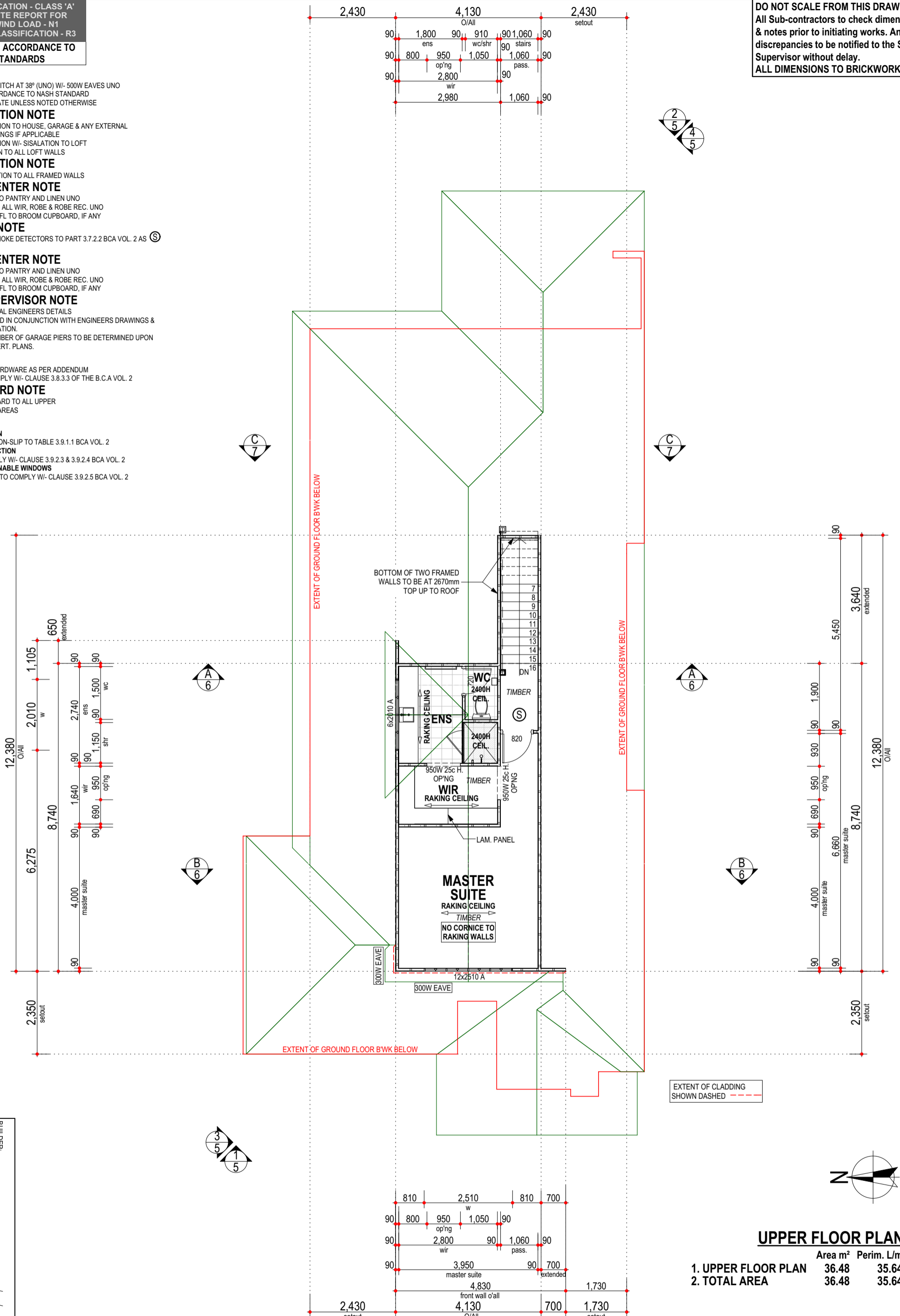

EXTENT OF CLADDING  
SHOWN DASHED

**UPPER FLOOR PLAN**

|                     | Area m <sup>2</sup> | Perim. L/m |
|---------------------|---------------------|------------|
| 1. UPPER FLOOR PLAN | 36.48               | 35.64      |
| 2. TOTAL AREA       | 36.48               | 35.64      |

|            |  |
|------------|--|
| BUILDER:   |  |
| CLIENT(S): |  |
| WITNESS:   |  |

TANGENT NOMINEES PTY LTD (A.C.N. 008 865 585)  
TRUSTEE FOR THE SUMMIT HOMES GROUP UNIT TRUST.

242 LEACH HIGHWAY MYAREE, W.A. 6154.  
TELEPHONE (08) 9317 0100 FAX (08) 9330 4507

PROPOSED RESIDENCE FOR:  
**TANGENT HOMES NOMINEES**  
ADDRESS  
**LOT 375 PALLIUM WAY,  
JINDALEE**

**VARIATIONS:**  
PRESTART - 26.08.16 - DOS  
CERTIFIEDS - 6.09.16 - DOS  
LSCAPE CERTS - 21.09.16 - DOS  
ERROR LOG - 11.10.16 - DOS  
V001 - 4.11.16 - ELEC - DOS  
V002 - 8.12.16 - AIR CON - DOS

V003 - 10.03.17 - LOFT INSULATION - THO  
V004 - 03.04.17 - ALFRESCO - THO  
V005 - 05.04.17 - KITCHEN SINK - THO  
V007 - 07.04.17 - BED 2 WINDOW - THO  
V008 - 13.04.17 - MASTER SUITE - THO  
V009 - 28.04.17 - CLADDING - AEN  
V010 - 01.06.17 - BBQ & R'HOOD - THO

LAST OPENED:  
Thu 01 Jun 2017  
TIME:  
08:19:36

DATE: 18.06.16  
DRN: DONNA  
CHD:  
SCALE: 1:  
© COPYRIGHT 2017